



Boldly Creative



Expert Customer Service



Focus On Quality



Ships Same Day

P360 Ultra Blanking Panel

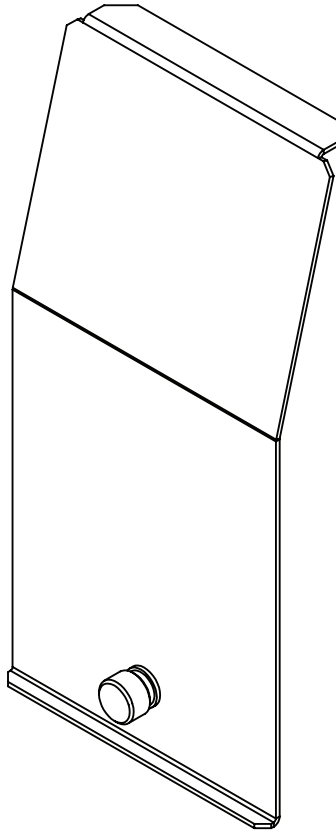

Installation Instructions

Kit P/N: 102-8986

Kit Contents

Kit Contents:

(1) P360 Ultra Blanking Panel

Installation Instructions

Step 1 Turn Locking Knob: Turn Locking Knob counter-clockwise until the Locking Bracket is as shown below.

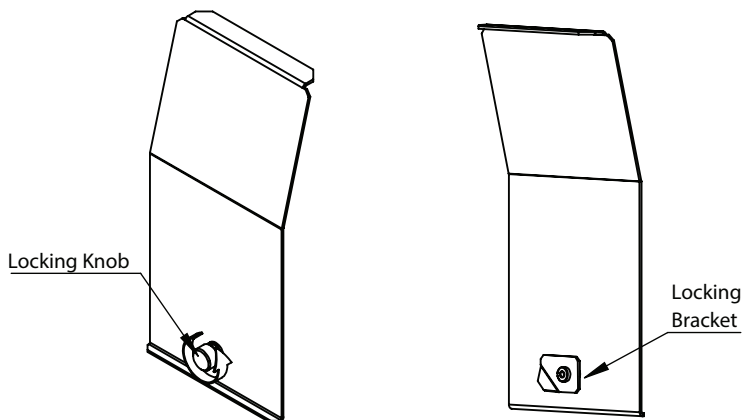

Step 2 Insert Blanking Panel: Insert the Blanking Panel into the desired slot location on the Hypershelf.

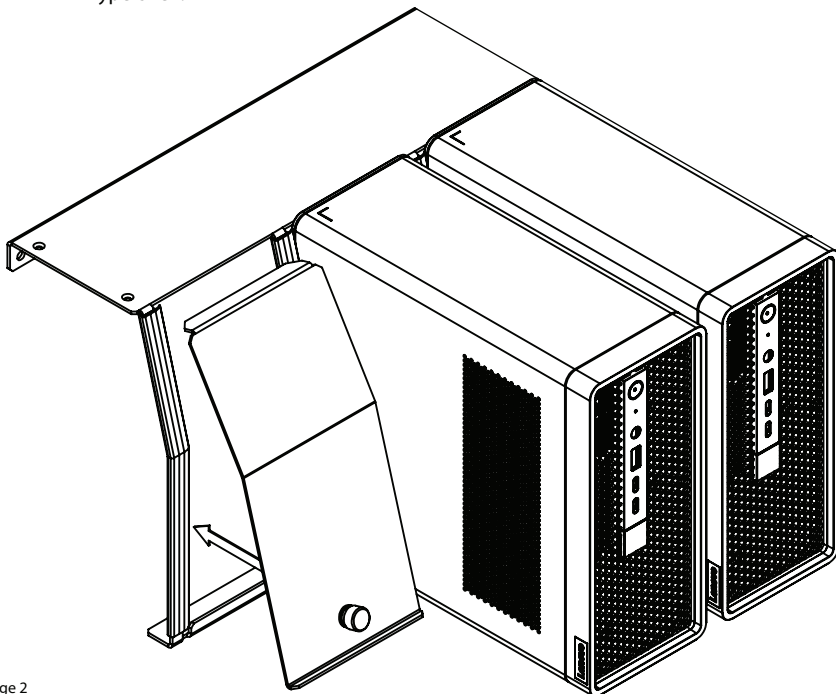

Step 3 Secure the Blanking Panel: Secure the Blanking Panel into place by turning the Locking Knob clockwise.

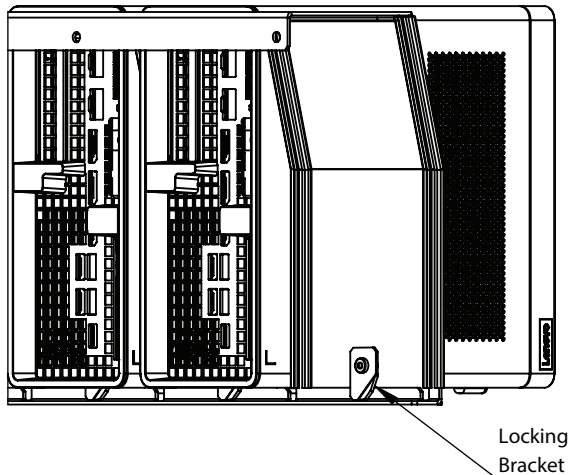
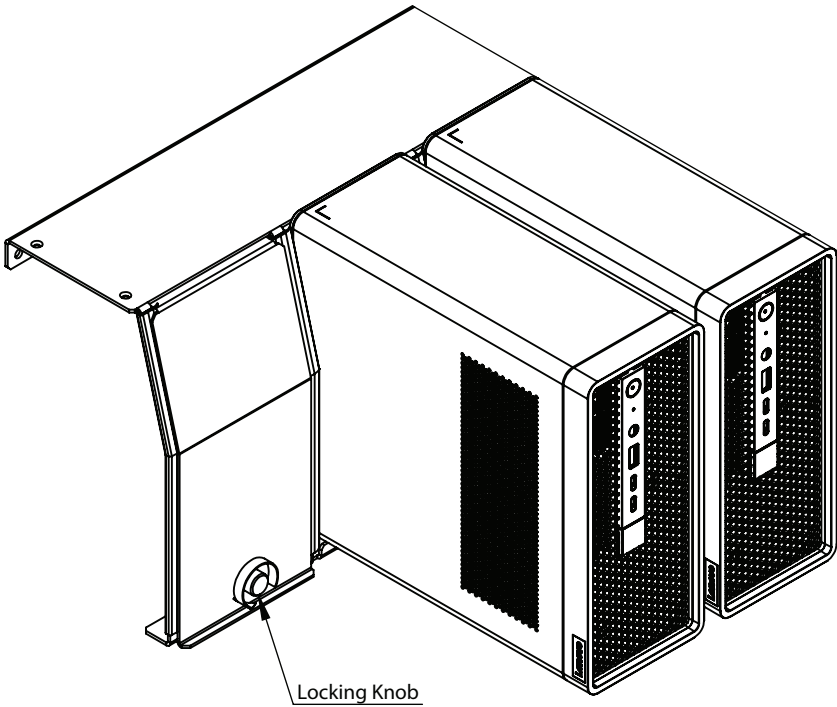



Boldly Creative



Expert Customer Service



Focus On Quality



Ships Same Day

You're going to ♥ working with us Global company - small town service

Custom Engineering

Our top notch (in-house) mechanical and electrical engineers are available to solve your toughest custom design challenges.



On-Site Manufacturing

Our manufacturing facility is on-site at our Texas headquarters. If we send them a drawing in the morning, we can have parts ready to ship-out that evening.

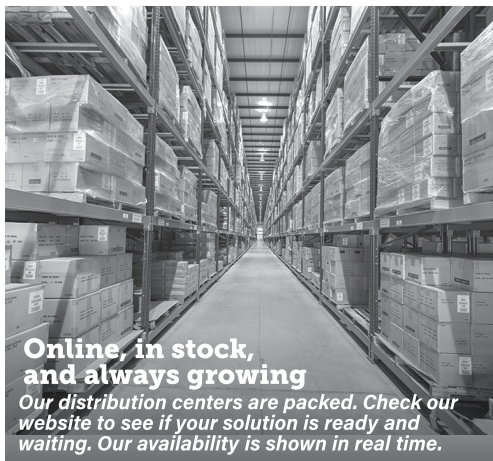

Online, in stock, and always growing

Our distribution centers are packed. Check our website to see if your solution is ready and waiting. Our availability is shown in real time.

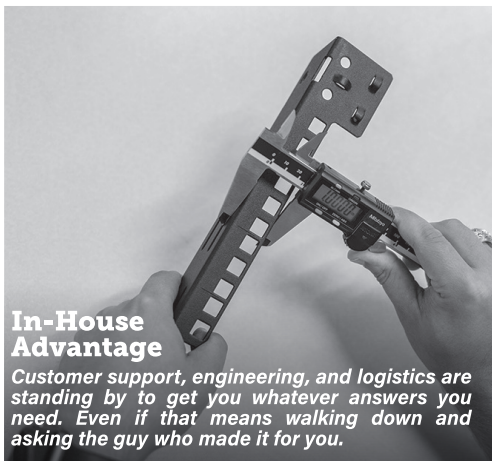

In-House Advantage

Customer support, engineering, and logistics are standing by to get you whatever answers you need. Even if that means walking down and asking the guy who made it for you.

Warranty Statement

Innovation First, Inc. warrants our products against defects in material and workmanship for a period of one (1) year from the date of purchase. Innovation First, Inc. liability shall be limited to repairing or replacing, at our option, any defective product.